



MOUNTING INSTRUCTIONS

OS-NET sensor is available with multiple mounting options with or without a mounting bracket. These mounting options allow the sensor to be integrated with lighting fixture or mounted on the ceiling in various ways.

Ceiling Surface	S-mount with SMB-500
	<p>Assemble the sensor unit with front cover and tighten the screw nut with torque no higher than 0.3 lb-ft.</p>

Junction Box	C-mount with CMB-500

Ceiling Recess	R-mount with RMB-500	L-mount with LMB-500

Fixture Integrated F-mount

IP-66 Fixture Integrated W-mount

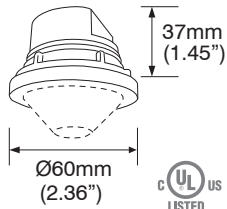

Sensor assembly hole on the fixture

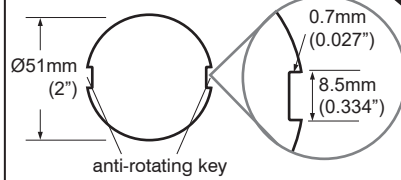

1

Sensor assembly

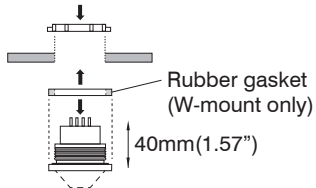

Assemble the sensor into the hole, and tighten the screw nut with torque no more than 0.3 lb-ft.

Note: For IP-66 fixture integration, ensure the rubber gasket is placed in between the fixture enclosure and sensor unit.

2

3

Light fixture

Fixture External E-mount with EMB-500

IP-66 Fixture External P-mount with PMB-500

EMB-500 & PMB-500

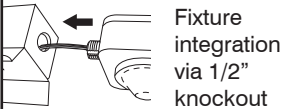
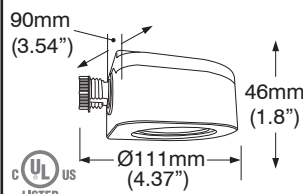

Sensor with wire leads

1 Assemble the sensor with fixture via the knockout hole

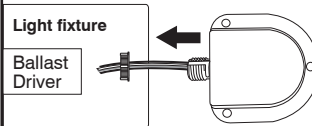

2 Tighten the screw nut

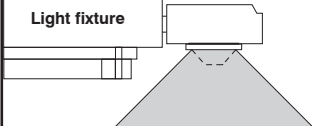
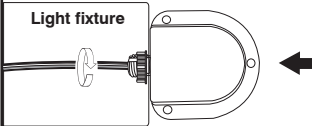

Note: For IP-66 fixture integration with PMB-500, ensure the rubber gasket is placed in between the fixture enclosure and sensor unit.

POLE MOUNT

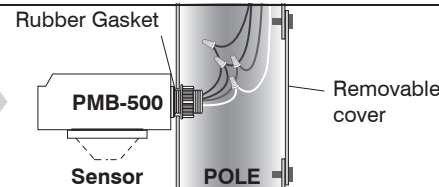

E-mount with EMB-500

P-mount with PMB-500

Plug (PMB-500 only)

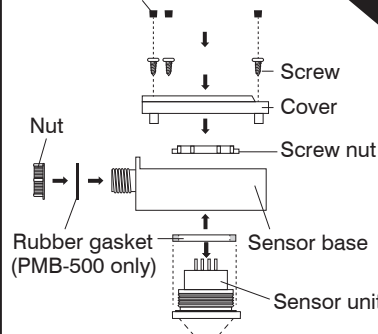

Sensor with terminal block

1 Remove the top cover and assemble the sensor with fixture via the knockout hole

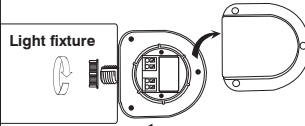

2 Lead the wires through the hole and connect to the terminal block

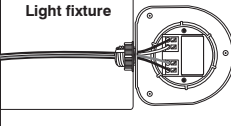

3 Restore the top cover and tighten the screws. Seal the screw holes with rubber plugs

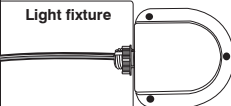

ACCESSORIES

Extension Mounting Adaptor EMA-500

EMA-500

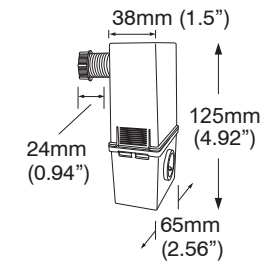

The EMA-500 is an Extension Mounting Adaptor designed for the sensor with EMB-500 or PMB-500. It can be used to lower the mounting position of sensor to prevent the coverage of PIR based occupancy sensor being blocked by the fixture body or enclosure.

This is not a UL approved mounting option for line voltage sensor.

Assemble with EMB-500

1 Separate the adaptor

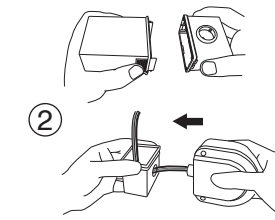

3 Click!

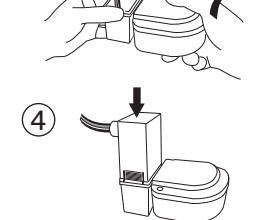

1

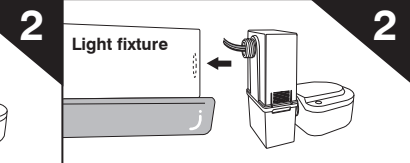
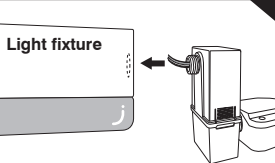

2 Light fixture

2 Light fixture

If the lighting fixture has a wider lower enclosure, use double screw nuts on the threaded nipple to prevent sensor being tilted.

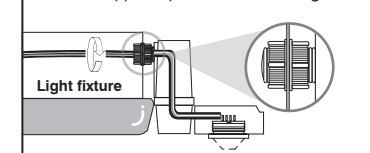
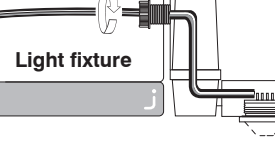

Extension Joint

EJ-30 / EJ-50 / EL-40

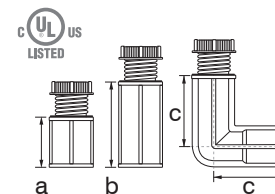

a EJ-30
30mm(1.18")
b EJ-50
50mm(1.97")
c EL-40
40mm(1.57")

With E/P - mount

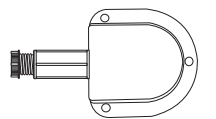

The EJ-30, EJ-50 and EL-40 are extension joints that can be used to extend the E/P mount sensor position for 30, 40 and 50 mm. Combine the joints if longer extension is required. For outdoor use, order EJ-30F, EJ-50F or EL-40F.